

NUVO[®]: MULTI-ROOM AUDIO SYSTEM

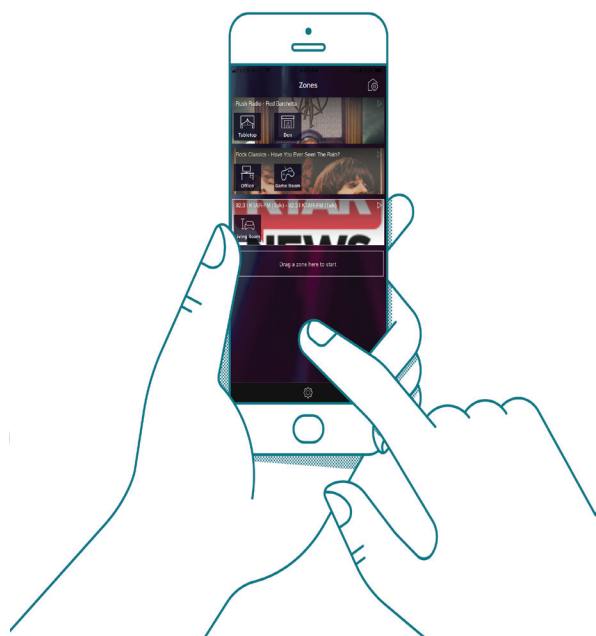

HIGH QUALITY
DIGITAL MUSIC
IN EVERY ROOM
OF THE HOUSE



Contents

4-11

General features

NUVO - high quality digital music in every room of the house	4
Wireless solution	6
Wired solution	7
System components	8

13-18

Project guidelines

Type of LAN network	13
Player selection	15
Speaker selection and positioning	16

13-22

Wiring diagrams

Example 1 - System wired for sound system in 4 zones with maximum power 2 x 20 W (centralised solution).	19
Example 2 - System wired for sound system in 4 zones with maximum power 2 x 20 W (stand-alone solution)	20
Example 3 - System wired for sound system in 3 zones with maximum power 2 x 50 W and extension with a wireless zone	20
Example 4 - wireless system for sound system in 4 zones with maximum power 2x60 W and integration with A/V amplifiers of other brands	21
Example 5 – Wireless system to play sound in 4 zones (one of which is dedicated to managing the TV sound) with a maximum power of 2 x 60 W	22

23-30

Catalogue

NUVO

HIGH QUALITY DIGITAL MUSIC
in every room
of the house



FROM RADIO BROADCASTS AND COLLECTIONS OF MUSIC ON CD....



Spotify

iTunes

In recent years developments in electronics have contributed to a gradual replacement of analogue sound sources (FM radios, CD players etc.) by high-quality audio sources in digital format.

Stored on PCs, local hard disks and Cloud services as personal libraries or available streamed from the Internet, digital audio is more and more often played for local listening by Tablets and Smartphones.

Rock music in the dining room, classical music in the bedroom and jazz music in the living room.

Legrand's NUVO solution is now available to play audio in various rooms in the home with Hi-Fi sound levels and quality.

Using zone players linked to high-quality speakers, NUVO allows you to listen to your favourite music saved on Smartphone or Tablet on storage devices (USB keys), shared online in iTunes and Windows Media libraries or available from Internet services such as streamed radio and Cloud services, in every room of the home, up to a maximum of 16.

All the functions are freely controlled by Tablet and Smartphone with a specific APP which can be downloaded free from the Android Play Store and the Apple Store.

TO DIGITAL AUDIO SHARED VIA LAN NETWORK AND INTERNET



Wireless SOLUTION

The ideal solution for flexible and fast systems with minimal structural interventions.

6.5" PLASTERBOARD SPEAKERS, SERIES 6



TABLETOP SPEAKER



WIRELESS ZONE PLAYER



Internet

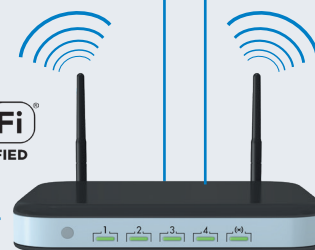

Router Wi-Fi

LAN

The system

Easy to install and configure, the multiroom digital audio system consists of zone amplifier devices (players) connected to the speakers and to the home LAN network in order to listen to several audio files at the same time in the different rooms, up to a maximum of 16 audio files.

There are two installation modes:

- wired solution, suitable for new houses fitted with wired LAN network;
- dual-band wireless (2.4 and 5 Ghz) solution for existing homes or to extend wired systems, in rooms of new homes without wired LAN network.

Wired SOLUTION

Ideal for sound systems in rooms with wired LAN network and to centralise players in racks.

OUTDOOR SPEAKER

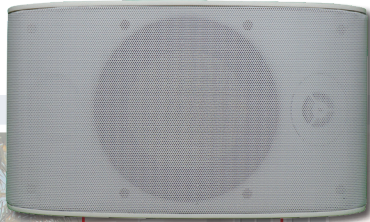

6.5" CEILING SPEAKERS, SERIES 2

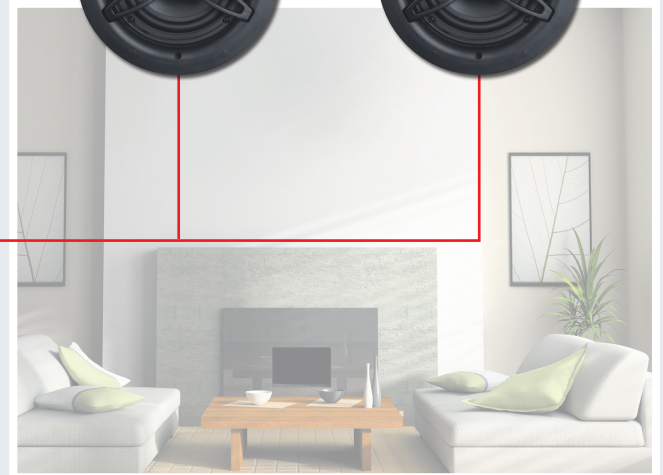

MULTI-ZONE PLAYER



KEYPAD

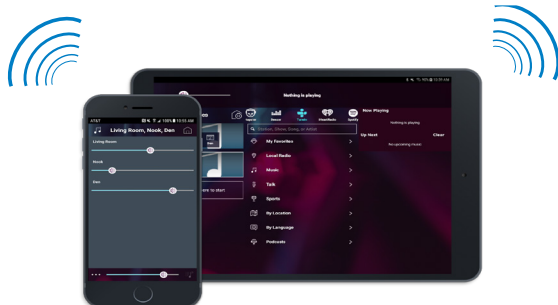
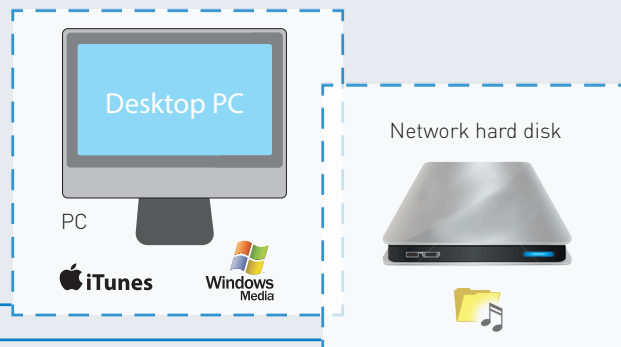

NUVO APP

Connect and listen to

A specific APP, available free from the Android and iOS stores, configures the devices and manages all the system functions using just a Tablet or a Smartphone connected to the home Wi-Fi network.

SYSTEM components

Zone player

The players are Hi-Fi quality “Class D” audio stereo amplifier devices, connected to the home speakers and data network. They process and amplify audio signals.

They are available in different versions.

Zone player with integrated speaker

Made up of a speaker connected to a zone player, this Tabletop item NV-P400 allows you to listen to your favourite music in every room of the home with maximum freedom. Intended for tabletop installation, it can be used as a single zone player or as an extra player to extend the zones of an existing system.



DIN Audio Player P600

The NV-P600 is designed for the international DIN rail mounting standard which is heavily adopted throughout Europe. It gives any room instant access to endless music options from networked collections or a variety of internet radio and streaming services - all from a single, intuitive app.



Soundbar with subwoofer for Home Theatre P500

With a powerful 2.1 system, complete with an 8" wireless subwoofer, the Soundbar boosts listening experiences, playing movie, TV, or audio clarity. The Soundbar can also be used as a zone player which can guarantee access to music playlists in the network and streaming services.





Rack professional multi-zone player

Player to be mounted in modular rack panels and to create a sound system in a maximum of three different zones.

There are the following available powers for every zone:

- 2x20 W RMS (item NV-P3100)
- 2x55 W RMS (item NV-P4300)
- 2x25 W RMS (item NV-P5050)
- 2x 50 W RMS (item NV-P5100)
- 2x100 W RMS (item NV-P5200)

Suitable for wired LAN network connection.



3 ZONE PLAYER

Stand-alone zone player

Device for creating a sound system in one zone available in two versions: with power of 2x20 W RMS item NV-P100 and 2x60 W RMS item NV-P200.

Suitable for wired and wireless network connection.



SINGLE ZONE PLAYER

Pre-amplified zone player

This device, item NV-P300, is specially made to use an audio or audio/video power amplifier of other brands for the sound system of a zone. Suitable for wired and wireless network connection.

Available connections

The players have USB port and IN audio connector, to which mobile devices such as Pen drives and MP3/CD readers can be connected.

This solution allows further audio files to be added for home listening, as well as those stored in the devices on the LAN network (hard disk and computer) and those streamed via Internet.

The wireless player item NV-P200 can also be connected via Bluetooth to your tablet or smartphone to play your favourite playlists.

NOTE: the amplifier power refers to 8ohm speaker connection.

SYSTEM components

Speakers

The speakers are available with powers between 50 – 100 W RMS and with various shapes and modes of installation.

Indoor speakers

They are ideal for ceiling and wall mounting and available in three different series:

- SERIES 2: speakers with polypropylene woofer for deep basses and tweeter with silk dome for crystal-clear sounds; applicable power up to 50W RMS.

- SERIES 4: speakers with glass fibre woofer for a minimum distortion and tweeter with aluminium dome for bright sounds; applicable power up to 75W RMS.

- SERIES 6: speakers with Kevlar and carbon fibre woofer for high powers and titanium tweeter for extreme performances; applicable power up to 100W RMS.



SERIES 2



SERIES 4



SERIES 6

Outdoor speakers

The new outdoor speakers feature powerful and crystalline sound thanks to the use of a woofer with 6.5" diameter. The elegant design combines small size and a modern appearance which fits perfectly in any space.



Landscape speakers

Deliver immersive sound throughout any outdoor environment with the durable and scalable Nuvo Series Two Landscape Speaker Kit, complete with four, two-way satellite speakers and an eight inch, in-ground subwoofer.



LCR Speaker

The Nuvo Series Two In-Wall LCR (Left, Center, Right) speaker delivers balanced, moderate sound from a single, slender speaker.



Subwoofers

The line of Nuvo powered subwoofers is available in 8", 10" and 12" - the line of Nuvo passive subwoofers is available in-ceiling or in-wall. The subwoofers work with almost any AV system to bring a whole new dimension of deep and detailed clarity to custom audio installations.





The function control

Touch screen item NV-P30-BK and NV-P30-WH

Used as an alternative to the tablet, this wall-mounting device has an elegant 10" screen for complete control of the NUVO system. The touch screen already has an operation application. It is available also in white colour.



Keypad item NV-P10 and NV-P20

Featuring an elegant front with backlit symbols, this device is a convenient flush-mounted control to manage the basic functions of a single zone player. Extended options for Livinglight, Arteor, Valena.

Available in Magnesium, Anthracite, Tech, Aluminium, Ivory and White versions.

NUVO APP for system control

A single and specific app is available free from the Android Play Store or the Apple App Store for the configuration, system diagnostics and management of all the listening functions.

This will let you manage the entire NUVO system freely and anywhere in the house by selecting the audio sources (local audio libraries, Internet streaming services etc.) to be associated with the various rooms which will have a sound system.

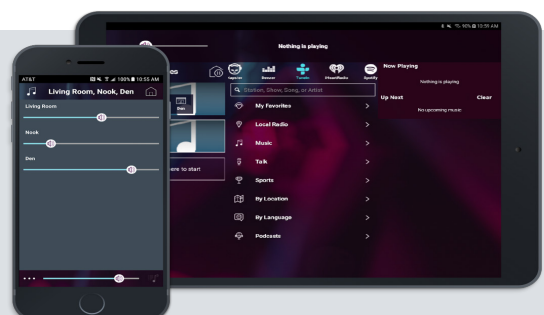

SEAMLESS THIRD PARTY INTEGRATION

With pre-written drivers, it's easy to integrate the exceptional audio of Nuvo into advanced control systems from KNX, Vantage and more, for a streamlined user experience and comprehensive home control.



VANTAGE

Working with Vantage allows any integration that is so simple for an installer to apply, but even easier for a homeowner to love. Equinox interface gives you the freedom to control your multi-room audiosystem and get full metadata feedback. The comprehensive driver for integrating the two systems, all-in-one LCD touchscreen provides intuitive control for luxury spaces.

KNX

The Nuvo KNX interface is a versatile bridge between the Nuvo players & KNX, making it easy to integrate Nuvo players in any KNX system. Nuvo whole home audio systems guarantee an unparalleled listening experience, with wired and wireless distributed audio solutions specially designed to match incredible fidelity with the latest in streaming source variety and intuitive control. Easy to install, easier to enjoy, Nuvo systems are the perfect fit for any home. And with this interface you can integrated Nuvo whole home audio systems in any KNX installation.



OTHER

Nuvo is also integrated with many other brands, such as:

- Bticino-Legrand MyHome
- Crestron
- Control 4
- RTI
- URC
- Key Digital
- DemoPad
- HomeSeer
- Elan
- Teletask



PROJECT GUIDELINES

The following factors must be taken into account when designing the NUVO audio multiroom system:

- A. type of home LAN network available or to be created: wired or Wi-Fi.
- B. number and type of player as a function of the zones to be fitted with a sound system and the audio power.
- C. speaker type and positioning.

A. TYPE OF LAN NETWORK

To use all the functions of the NUVO system it must be connected to a LAN network with Wi-Fi modem/router. The Internet connection must be available so that you can use the streamed music services and for any firmware updates of the products and the management APP.

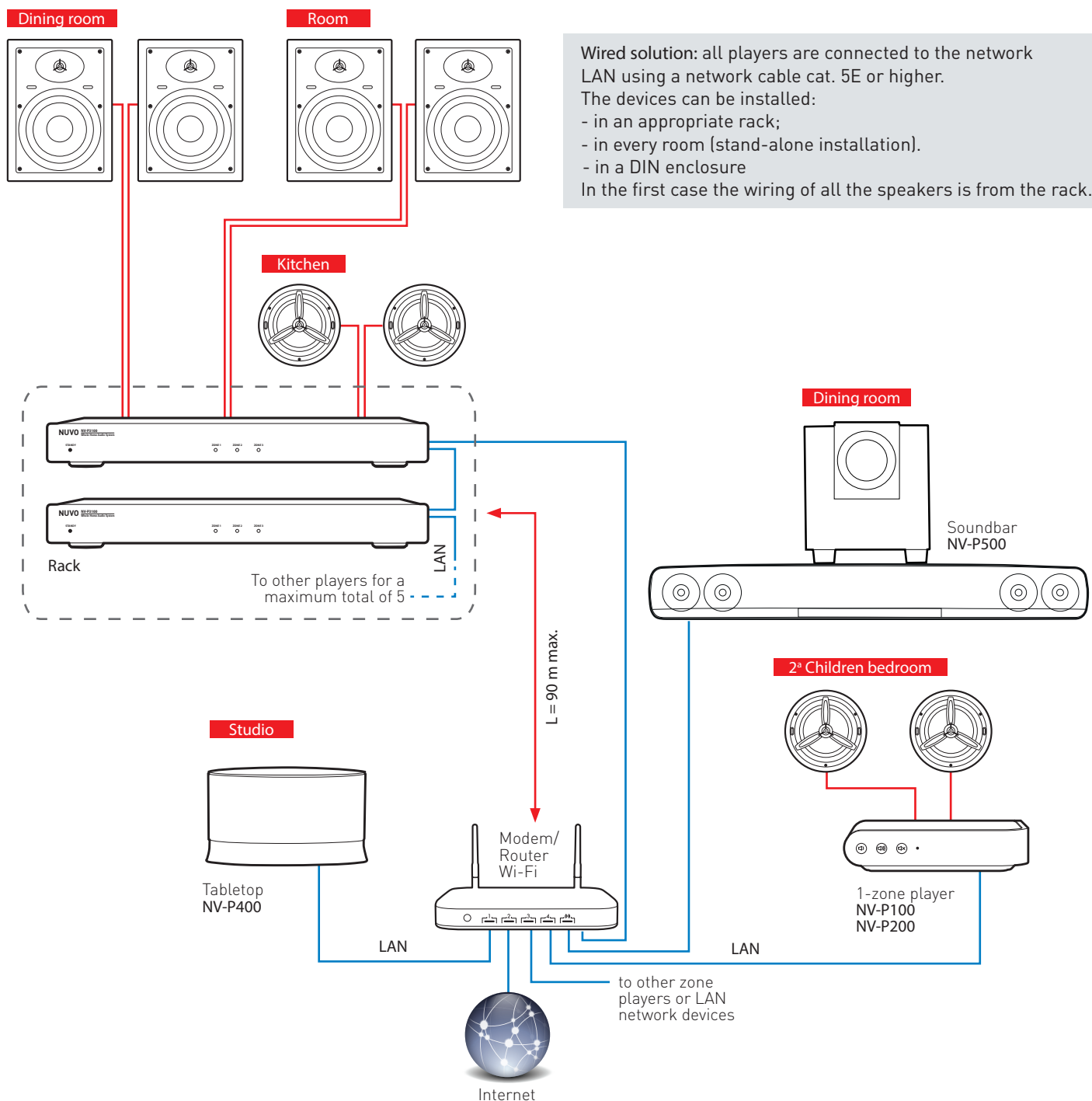

NOTE: it is possible to create a system that can manage up to 16 different zones.
Follow the provisions of the standards in force when making the LAN network data system.
It is recommended the use of cables with cat. 5E or higher.

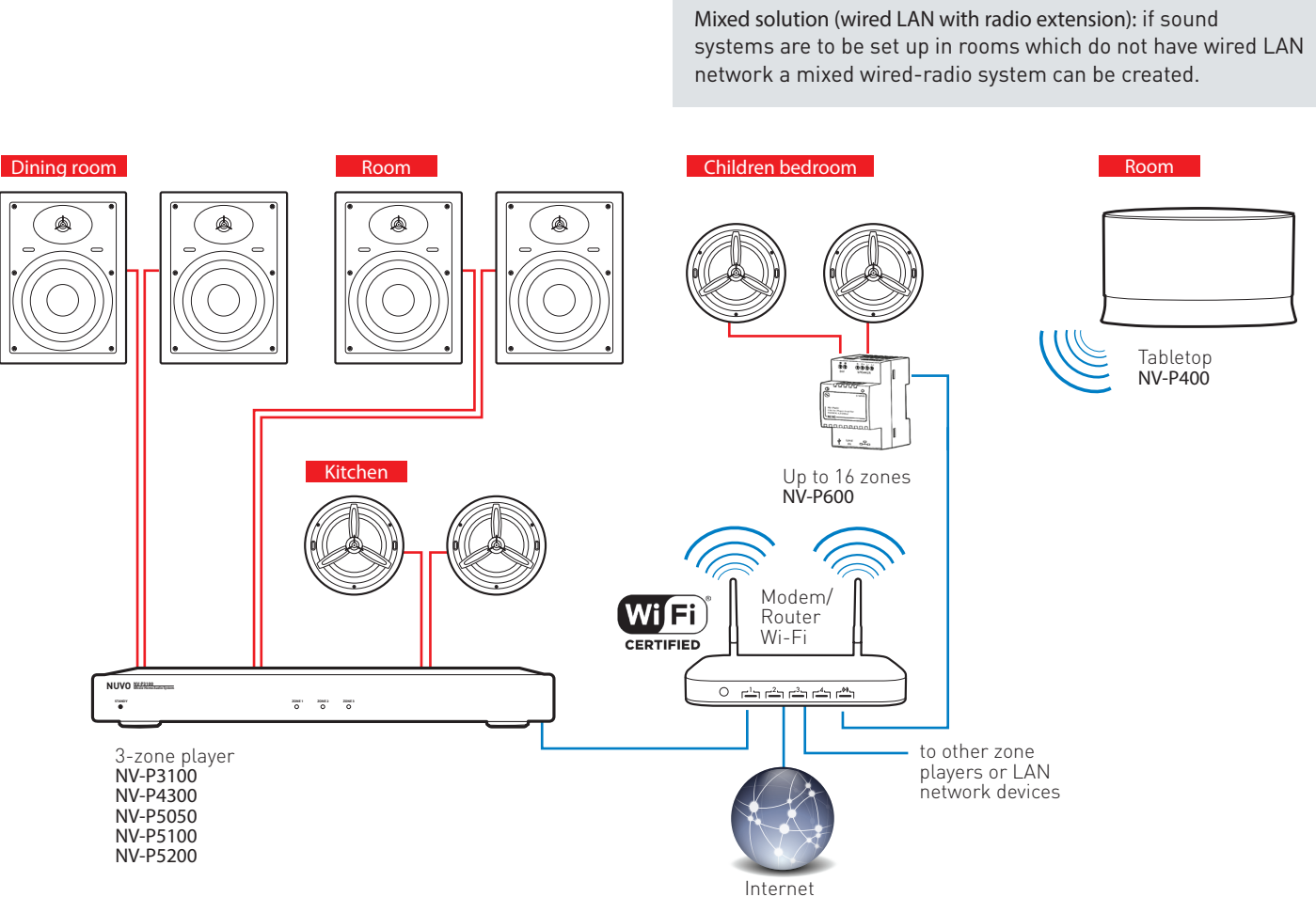
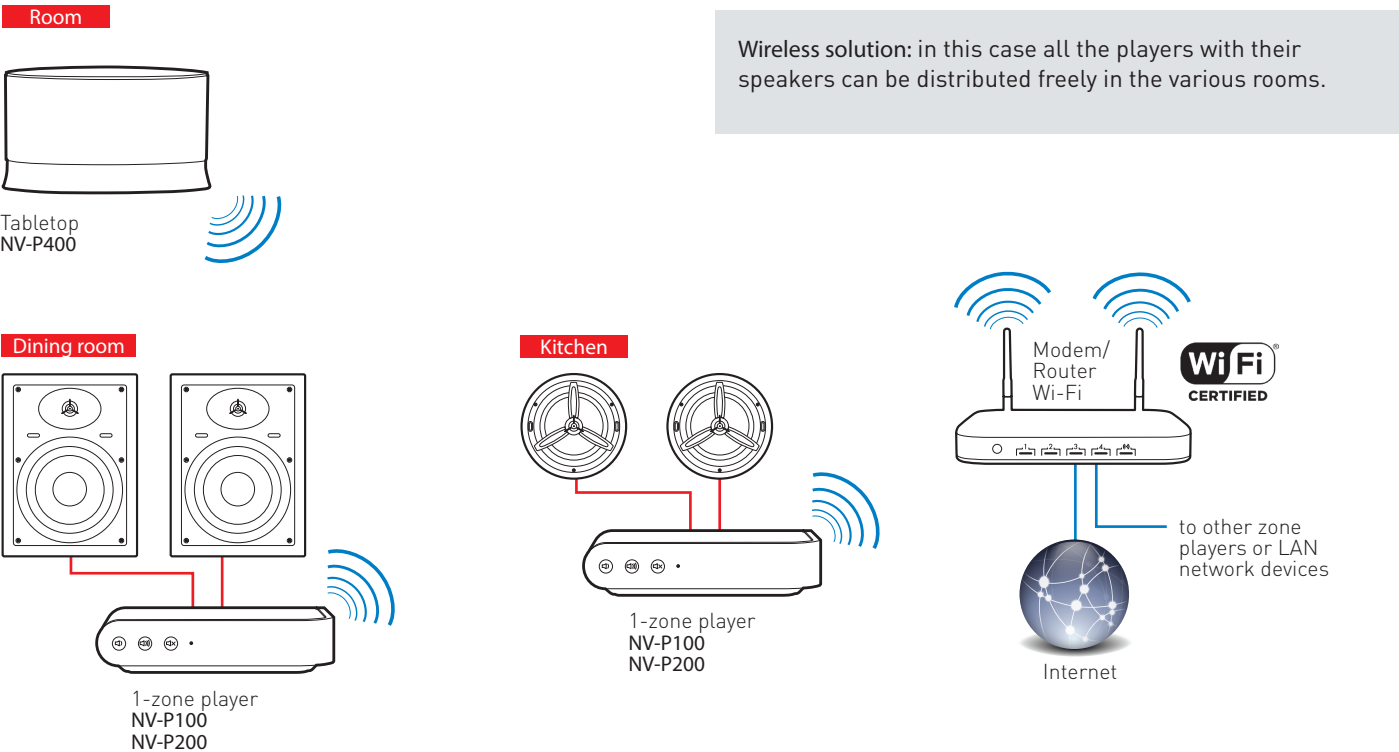

B. PLAYER SELECTION

After establishing the type of system to make, with wired LAN network, Wi-Fi or mixed, select the player and speakers to be used with it taking account of:

- the user’s listening habits: quiet background music or full volume;
- from the size of the room to be fitted with a sound system.

An applicable criterion in most cases is to assign players with power 20W (per speaker) for sound systems in small rooms such as small kitchens, corridors, bathrooms and small

bedrooms. Players with power more than 50W are suitable for sound systems in medium-large rooms such as living rooms, basements, master bedrooms and outside rooms. Consult the following table to select the players on the basis of the criteria stated above.

Note: in the design also consider any external noise sources such as roads or industrial activities which could disturb listening to the music programme.

Player	Mounting	Connection to the LAN network	Bluetooth connection	No. of managed zones	Power per zone (8 Ohm speaker)	Power per zone (6 Ohm speaker)	Power per zone (4 Ohm speaker)
NV-P100	stand-alone	Wired + Wi-Fi	NO	1	20 W x 2	n.d.	n.d.
NV-P200	stand-alone	Wired + Wi-Fi	YES	1	60 W x 2	n.d.	60 W
NV-P4300	rack	wired	NO	3	55 W x 2	55 W x 2	55 W x 2
NV-P3100	rack	wired	NO	3	20 W x 2	20 W x 2	n.d.
NV-P300	stand-alone	Wired + Wi-Fi	NO	1	-	-	-
NV-P400	stand-alone	Wired + Wi-Fi	NO	1	n.d.		
NV-P500	stand-alone	Wired + Wi-Fi	NO	1	n.d.		
NV-P600	DIN enclosure	Wired	NO	1	20 W x 2	20 W x 2	20 W x 2
NV-P5050	rack	wired	NO	3	2 x 25 W	2 x 37,5 W	2 x 50 W
NV-P5100	rack	wired	NO	3	2 x 50 W	2 x 75 W	2 x 100 W
NV-P5200	rack	wired	NO	3	2 x 100 W	2 x 150 W	2 x 200 W

PREAMPLIFIER PLAYER
ITEM NV-P300

This device, without power amplifier, is not connected to the speakers but is designed to be connected to the input of any Hi-Fi amplifier already in the room.
The amplifier thus becomes an integral part of the NUVO system to play streaming audio content from Internet Radio or in the home network.



SOUNDBAR WITH SUBWOOFER
ITEM NV-P500

This device is the ideal solution to play high-quality sound from televisions or Audio/ Video receivers. As well as these functions, the Soundbar can be used as a zone player performing the same functions as the stand alone players and rack.



C. SPEAKER SELECTION
AND POSITIONING

This operation must be carried out taking account of the features of the room where the sound system will be installed and the player selected.

Respect the following rule:

- with 20 W Players use speakers with maximum power of 50 W;
- with 50/60 W Players use speakers with maximum power of 75 W or 100 W.

All speakers are set up for installation in brick or plasterboard walls (using the appropriate metal box item NV-BOXIW6) or for false ceiling installation.



PARTICULAR SPEAKERS

Speakers with features customised for special applications are available in the NUVO product range.

Angle speaker

These ceiling speakers have a front woofer and tweeter fixing flange horizontally oriented by 15 degrees to direct sound to the listening spot more efficiently.

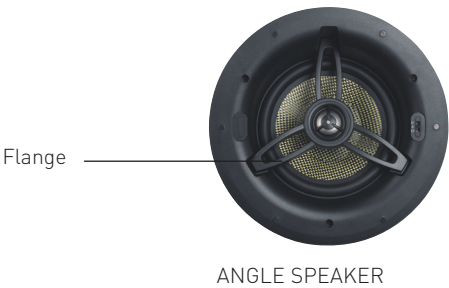

Stereo speaker

To be used in rooms which are too small for the installation of two speakers, to play stereophonic sound. The speaker has one woofer and two independent tweeters (one for the right channel and one for the left channel).

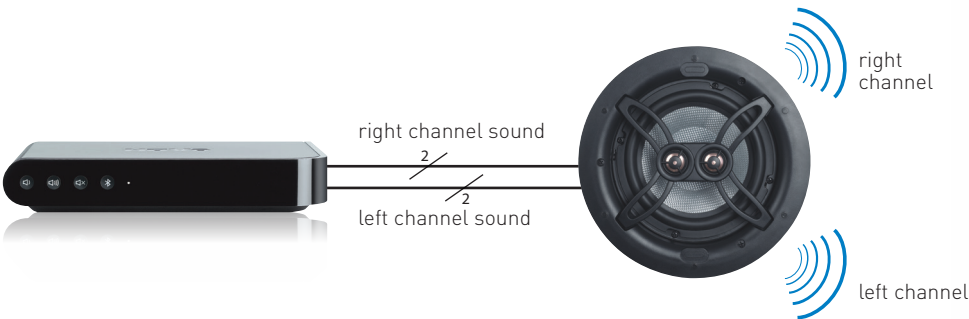

PROJECT GUIDELINES

C. SPEAKER SELECTION AND POSITIONING

The speakers must be positioned in the various rooms taking account of the user's needs.

If there is only one listening position because the listener wishes to experience the stereo effect, the two speakers must be positioned at the corners of an equilateral triangle and the listener must be at the vertex.

If the listening position is not a fundamental requirement, the speakers can be installed on the wall or the ceiling and so positioned that the sound is uniformly distributed in each room. In medium sized or large rooms there should be 2.5 – 3 metres between two or more speakers installed on the same wall to guarantee wide sound distribution. The following pictures show some installation examples.

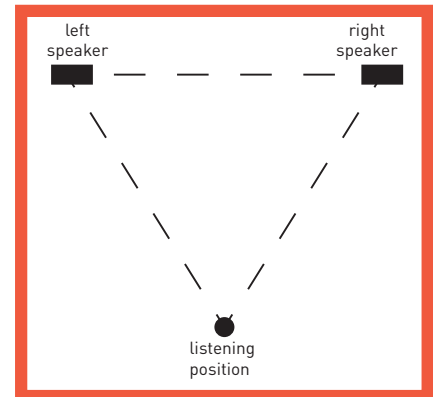

Positioning the speakers for stereophonic listening (room upper view)

Installation examples

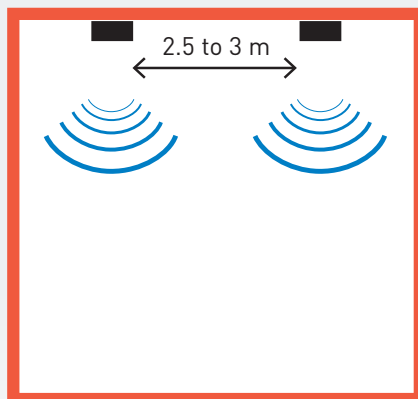

Fig. 1 - speaker positioning on the same wall (room upper view).

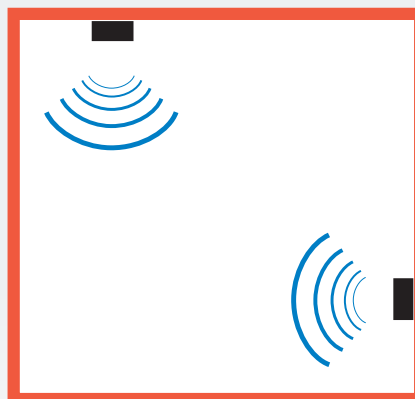

Fig. 2 - speaker positioning on two different walls (room upper view)

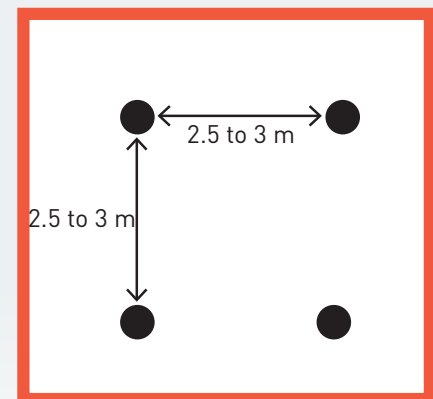

Fig. 3 - use of 4 ceiling speakers for sound system in large areas. Each pair of speakers is connected in parallel to each of the two outputs (right channel and left channel) of the player. This configuration is possible using only player item NV-P200 and item NV-P3500 and speakers with an impedance of 80hm (room upper view).

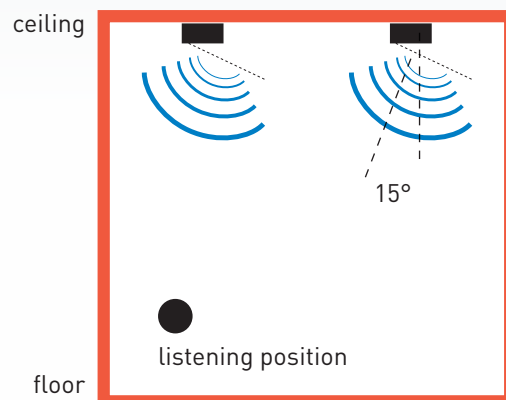

Fig. 4 - use of the ceiling "angle" speakers positioned for sound system in a specific area.

Connection cable selection

The wire which connects the players to the speakers, by its nature, attenuates the signal depending on its cross-section and length. For short connections, the signal attenuation level is very low because the value of the resistance (indicated by R_c in the drawing to the side) is negligible with respect to the value of the R_L impedance of the speaker (typically 8 Ohm).

For very great distances or for wires with smaller cross-sections, the wire resistance R_c increases with consequent increase in the loss of useful signal.

The cable selection must therefore be made taking account of the connection wiring length between the player and the speaker as shown in the following table.

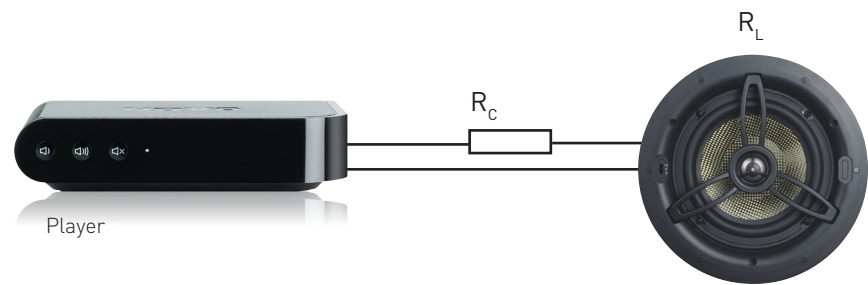

For the dimensions of the connection cables, refer to the data given in this table.

Maximum length of the Player connection cable - speaker (in metres)	Cable section (mm ²)
5	1
15	1.5
30	2.5
over 30	more than 2.5

The player must be connected to the speakers respecting the colouring of the terminals: the player's red terminal should be connected to the speaker's red terminal and player's black terminal connected to the speaker's black terminal. Failure to respect this rule may lead to a reduction of the emitted signal (speaker's right channel and left channel not in phase) or may lead to damage to the player or to the speakers.

To avoid any errors wires with two conductors distinguished by different colours or printing should be used.

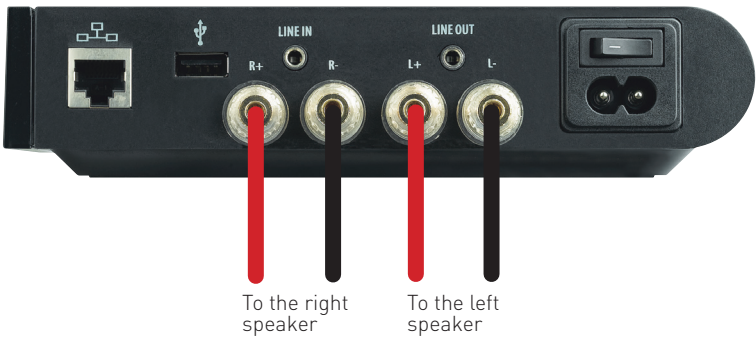

WIRING DIAGRAMS

EXAMPLE 1

SYSTEM WIRED FOR SOUND SYSTEM IN 4 ZONES WITH MAXIMUM POWER 2 X 55 W (CENTRALISED SOLUTION).

The diagram shows a new four-roomed apartment on a single floor with sound system fitted with wired and wireless LAN network. Two item NV-P4300 players will be used which can manage 3 zones each, centralised in an equipment room in the home; the first player manages the three zones (bedroom, bathroom and living room) and the second the fourth zone (kitchen). There are speakers item NV-6IW6 flush-mounted on the walls while in the smaller rooms such as the bathroom and the kitchen there are ceiling speakers item NV-6iC6.

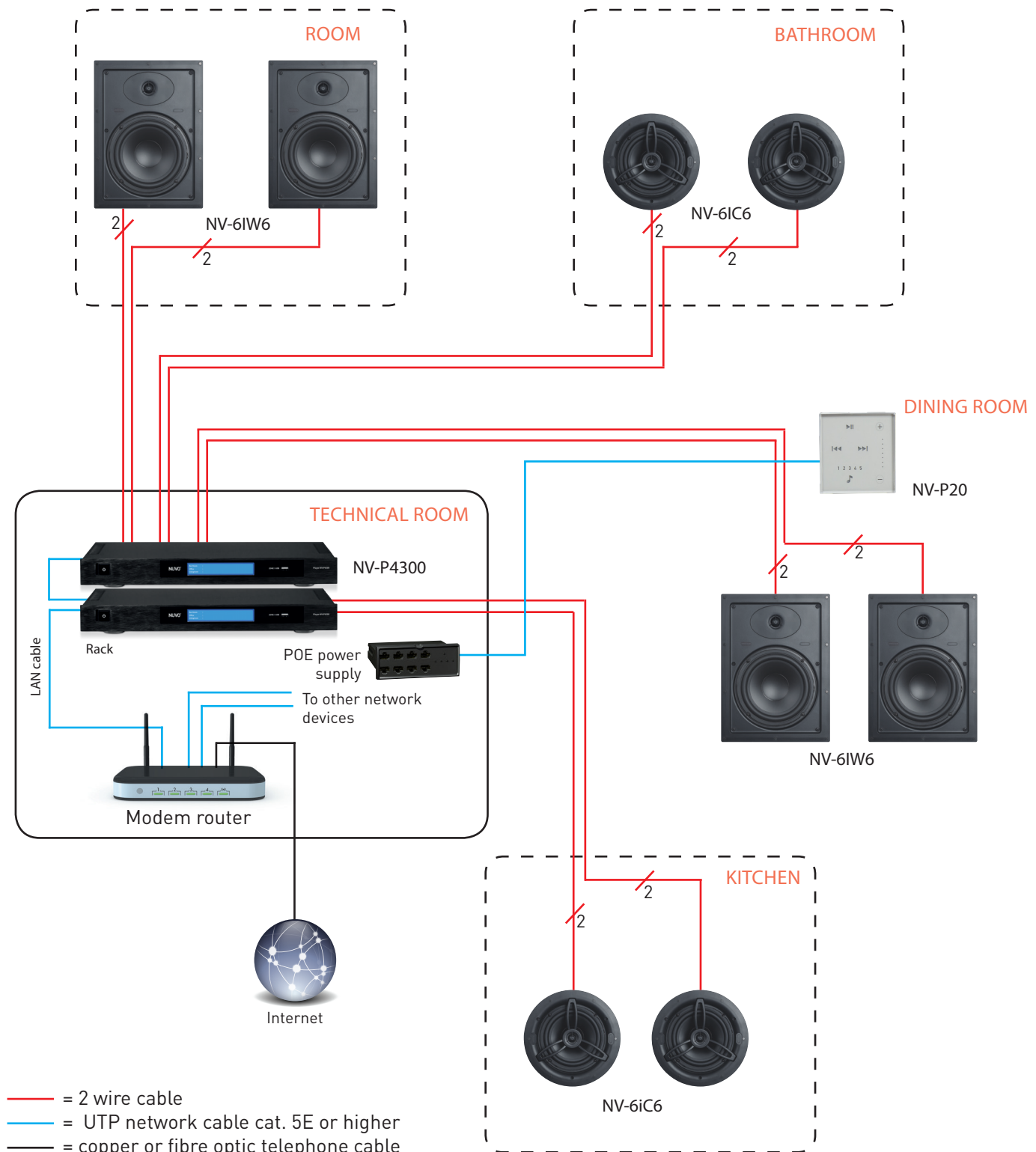

EXAMPLE 2

SYSTEM WIRED FOR SOUND SYSTEM IN 4 ZONES WITH MAXIMUM POWER 2 X 20 W (STAND-ALONE SOLUTION).

The system shown in the previous page can also be made using stand-alone player item NV-P100. In this case a wired LAN network must be installed in the home to connect each player to the modem router.

The LAN network can be sized for the connection of other network devices (hard disk, PC etc.).

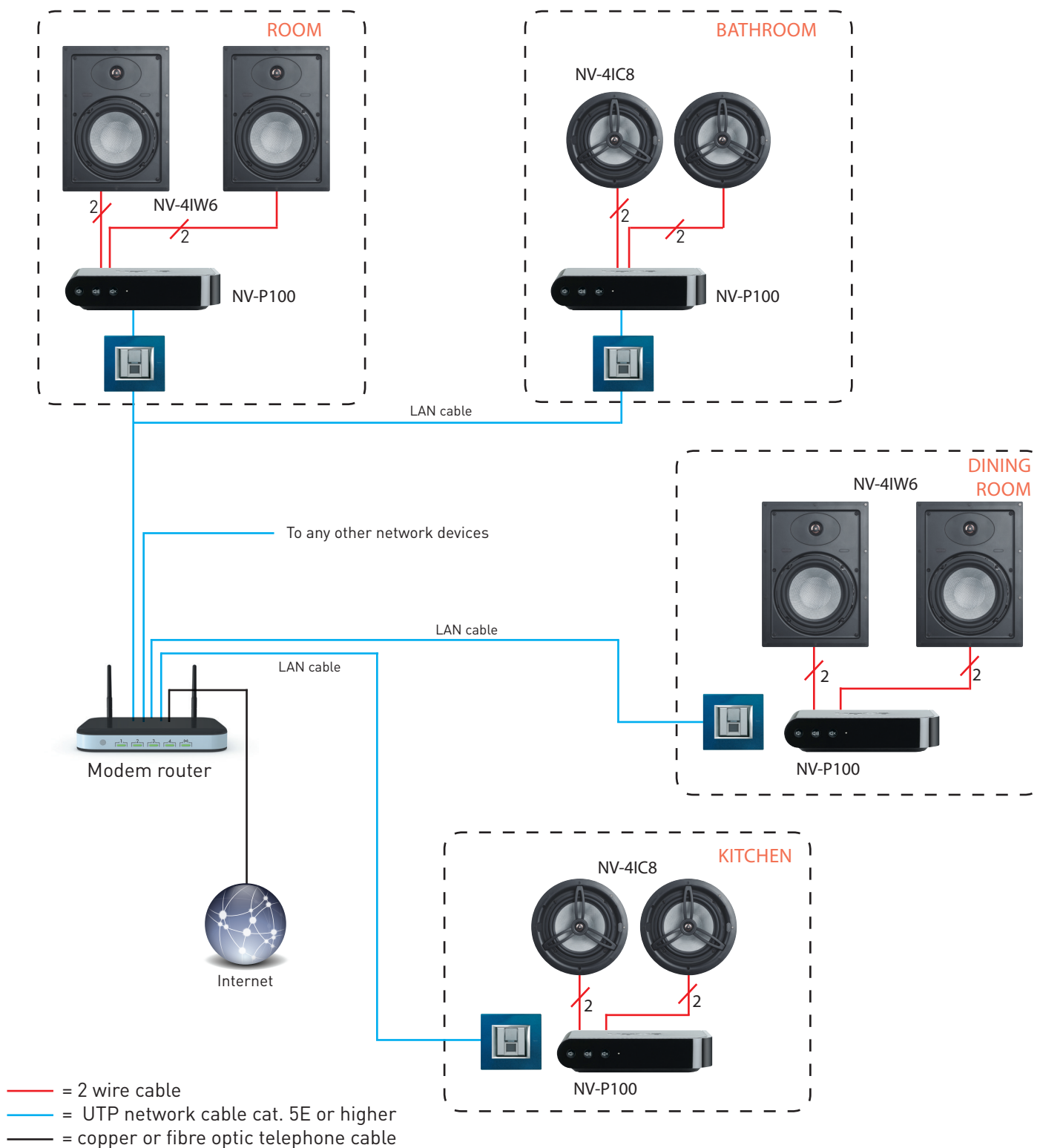

WIRING DIAGRAMS

EXAMPLE 3

SYSTEM WIRED FOR SOUND SYSTEM IN 3 ZONES WITH MAXIMUM POWER 2 X 100W AND EXTENSION WITH A WIRELESS ZONE

The system shown illustrates the use of a player item NV to manage 3 zones with maximum power 2 x 100W per zone. Use the Tabletop player item NV-5200 connected to the LAN via wi-fi to provide a sound system in the kitchen which does not have wired LAN.

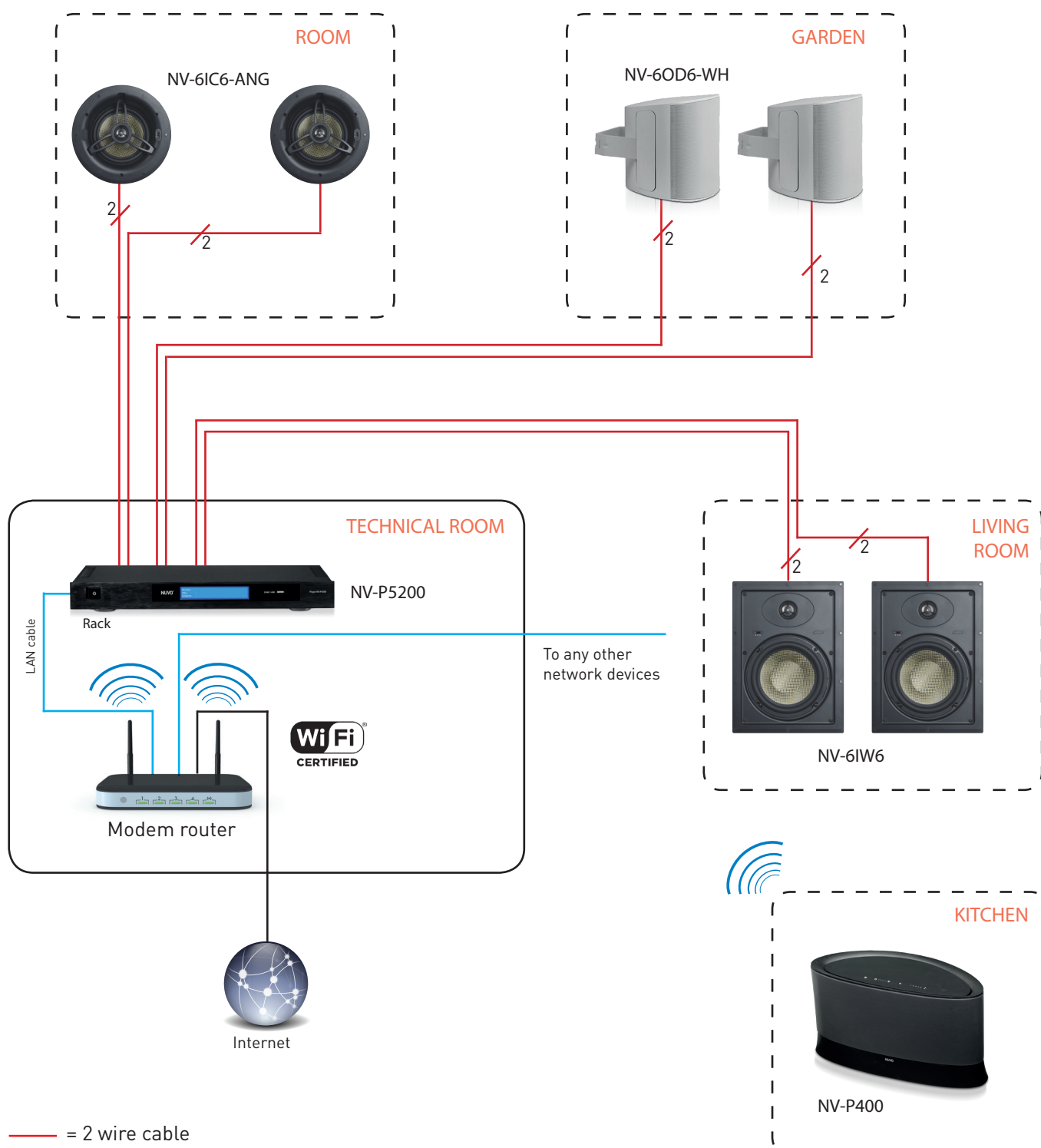

EXAMPLE 4

WIRELESS SYSTEM FOR SOUND SYSTEM IN 4 ZONES WITH MAXIMUM POWER 2X60 W AND INTEGRATION WITH A/V AMPLIFIERS OF OTHER BRANDS

This diagram shows the wireless system solution which is applicable in existing homes which do not have a wired LAN network, so that all players are interconnected to the router modem via wi-fi.

For sound system in the tavern or in the garden, the players item NV-P200 with maximum power of 2x60W are used. The “living room” zone is managed using the preamplifier player item NV-P300 connected to the pre-existing Hi-Fi system. Use the tabletop player item NV-P400_EU to listen to music in the bedroom.

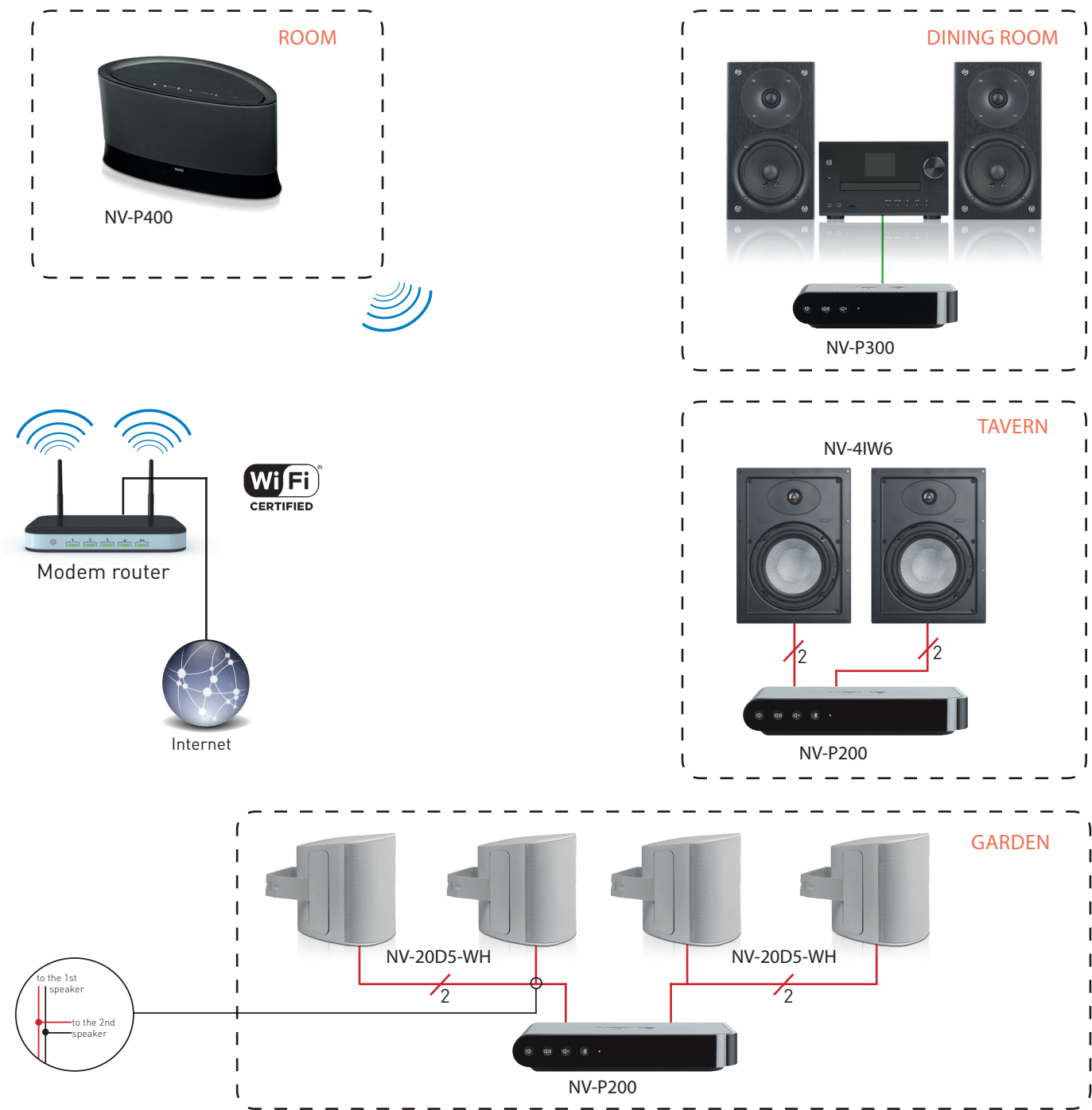

WIRING DIAGRAMS

EXAMPLE 5

WIRELESS SYSTEM FOR A SOUND SYSTEM IN 4 ZONES (ONE OF WHICH IS DEDICATED TO MANAGING THE TV SOUND) WITH MAXIMUM POWER OF 2X60 W.

Also in this diagram, the wireless system solution is shown.
The house contains a large tavern needing 4 speakers to distribute the sound evenly; these are connected “in parallel” to the right- and left-hand output sockets of the NV-P200 player with 60 W power.
In the living room, the TV is connected to the input of Soundbar item NV-P500 which plays high quality sound in the room by means of its indoor speakers and the connected subwoofer.
Use the tabletop players item NV-P400 to listen to music in the bedrooms.

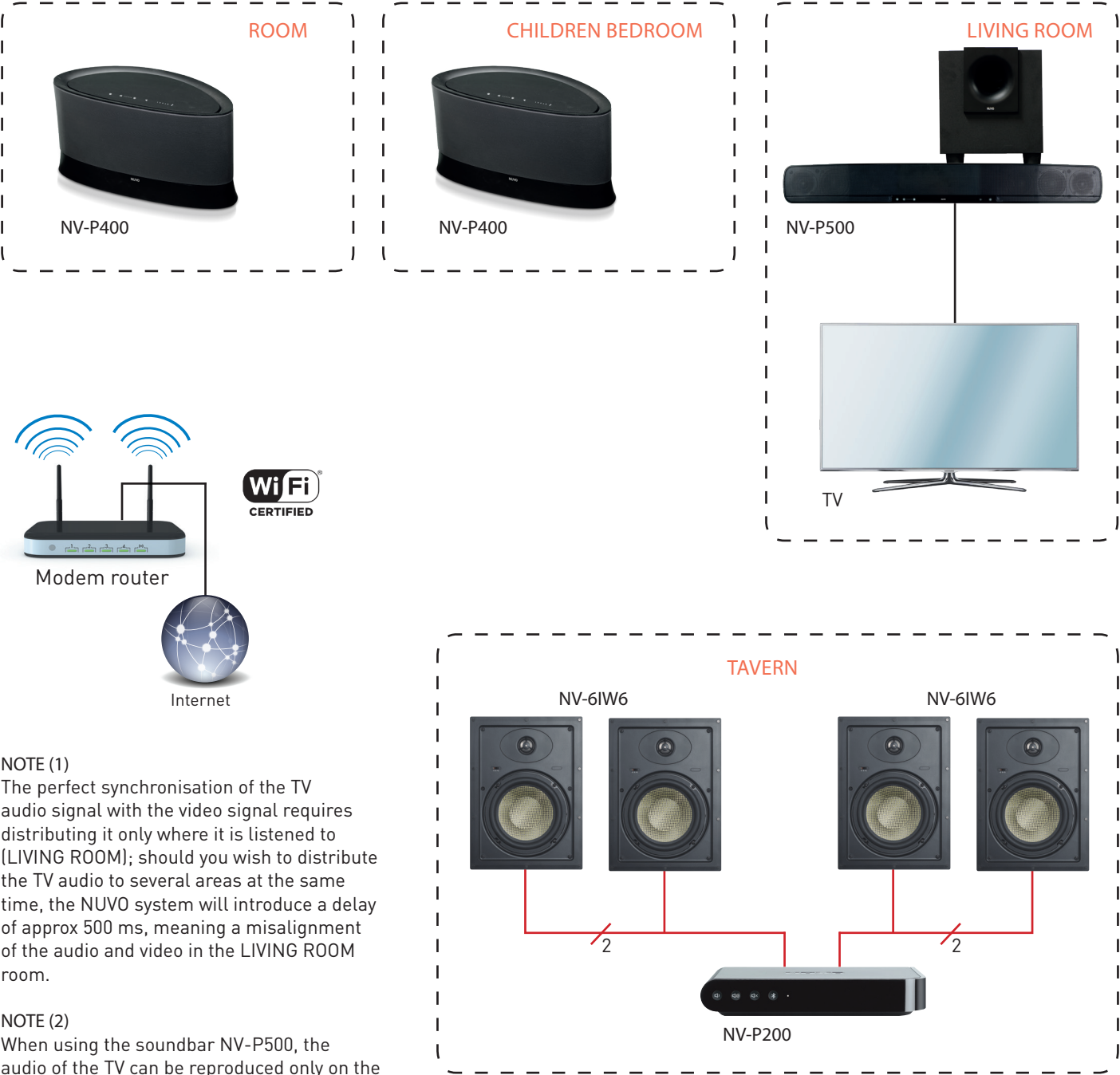

NOTE (1)
The perfect synchronisation of the TV audio signal with the video signal requires distributing it only where it is listened to (LIVING ROOM); should you wish to distribute the TV audio to several areas at the same time, the NUVO system will introduce a delay of approx 500 ms, meaning a misalignment of the audio and video in the LIVING ROOM room.

NOTE (2)
When using the soundbar NV-P500, the audio of the TV can be reproduced only on the soundbar itself. It cannot be distributed to other NUVO zones.

CATALOGUE

Zone player



NV-P100



NV-P4300



NV-P500



NV-P400



NV-P600

Item	RACK MOUNT PLAYERS
NV-P3100	Professional Rack version. Allows the management of 3 zones with rated output power for each zone of 2x20 W RMS. USB inputs and 3.5 mm jack to connect any other device - Speaker output impedance: 6 - 8Ω.
NV-P4300	Professional Rack version. Allows the management of 3 zones with rated output power for each zone of 2x55 W RMS with speakers of 8 Ω, 6Ω and 4Ω. USB and RCA inputs to connect any other device. It has a front touch screen to set and manage the functions.
NV-P5050	Professional Rack version. Purpose-built for custom audio installations. Providing 25 watts of power per channel at 8 ohms or 50 watts of power per channel at 4 ohms, the P5050 covers three listening zones in a space and energy efficient 1U rack design. I
NV-P5100	Professional Rack version. Purpose-built for custom audio installations. Providing 50 watts of power per channel at 8 ohms or 100 watts of power per channel at 4 ohms, the P5100 covers three listening zones in a space and energy efficient 1U rack design.
NV-P5200	Purpose-built for custom audio installations. This premium Player provides 100 watts of power per channel at 8 ohms or 200 watts of power per channel at 4 ohms. The P5200 provides powerful sound to three listening zones with an energy efficient 2U rack-mounted design.

Item	DIGITAL POWER AMPLIFIER
D460	Four channel digital Power Amplifier 4 x 60 W @ 4 Ω
D2120	Two channel digital Power Amplifier 2 x 120 W @ 4 Ω

Item	SINGLE ZONE PLAYERS
NV-P100	Wireless zone Player, Stereo Amplifier 2 x 20 W RMS. From the zone Player, it is possible to access the contents through the wireless or wired network. USB input and 3.5 mm jack to connect any other device. Speaker output impedance: 6 - 8Ω
NV-P200	Wireless zone Player, Stereo Amplifier 2 x 60 W RMS, aptX Bluetooth code. From the zone Player, it is possible to access the contents through the wireless or wired network. USB input and 3.5 mm jack to connect any other device. Speaker output impedance: 4 - 6 - 8Ω
NV-P300	Wireless zone player with preamplifier function made for linking to an audio or audio/video amplifier of other brands to play sound in the room to which it belongs. From the zone Player, it is possible to access the contents through the wireless or wired network. USB input and 3.5 mm jack for analogue and digital connection to the amplifier.
NV-P400	Tabletop speaker 2.1 combined with a zone player to listen to your favourite music in every room of the home. Intended for tabletop installation, it can be used as a single zone player or as an extra player to extend the zones of an existing system.
NV-P500	Soundbar 2.1 equipped with wireless 8" subwoofer. As well as its Home Theater use, the Soundbar can be used as a player of just one zone to listen to all the music available in the home network devices or in the various streaming services via Internet.
NV-P600	The DIN Rail Player, Stereo Amplifier 2 x 20 W RMS, built-in access to networked audio content, music stored on iOS or Android devices, or a variety of streaming services. Designed for the international DIN rail mounting standard.
NV-P601	The DIN Rail Power Supply is designed to power up to 4 individual P600 DIN Rail players. The Player Portfolio system is scalable and easy to expand by adding additional power supplies and P600 Players, for whole home audio in up to 16 zones

CATALOGUE



Control devices



NV-P30-BK







NV-P20-LLN

Item	7" TOUCH SCREEN
NV-P30-BK 	7" capacitive touch screen with resolution 1024 x 600 pixels to control all the NUVO system functions. Connection to the wired LAN via RJ45 cable and PoE power supply. Supplied with universal support for wall surface mounting. It is available also in white colour.
NV-P30-WH 	7" capacitive touch screen with resolution 1024 x 600 pixels to control all the NUVO system functions. Connection to the wired LAN via RJ45 cable and PoE power supply. Supplied with universal support for wall surface mounting. It is available also in black.

Item	KEYPAD
	Capacity control with backlit front cover to manage the basic functions of a single zone Player. Control of the play, pause, volume, mute and track search functions. Pushbutton to access your 5 favourite sources. Connection to the wired LAN via RJ45 cable and PoE power supply. 2 modules.
NV-P20-LLN NV-P20-LLNT NV-P20-LLNL	White Livinglight Tech Livinglight Anthracite Livinglight
NV-P20-ARMG NV-P20-ARWH NV-P20-VL-AL NV-P20-VL-JL NV-P20-VL-WH	Magnesium for Arteur, Celiane, Mosaic White for Arteur, Celiane, Mosaic Aluminium for Valena Ivory for Valena White for Valena
NV-NV-P2X	Accessory for the Keypad device to connect to the LAN. Length 15 cm

Speakers SERIES 2



Item	FOR CEILING INSTALLATION	
NV-2IC6		6.5" ceiling speaker, Series 2 (a pair) 50W RMS 8Ω
NV-2IC6-ANG		6.5" ceiling speaker, Series 2 (single) 50W RMS 8Ω - angle
NV-2IC6-DVC		Ceiling speaker with double tweeter 6.5" Series 2 (single) 50W RMS 8Ω
NV-2IC8		8" ceiling speaker, Series 2 (a pair) 50W RMS 8Ω
NV-2IC8-ANG		8" ceiling speaker, Series 2 (single) 50W RMS 8Ω - angle

Item	FOR WALL AND FLUSH MOUNTED INSTALLATION	
NV-2IW6		6.5" wall speaker Series 2 (a pair) 50W RMS 8Ω. For flush mounted installation in cement or brick walls, use the box item NV-BOXIW6.

NOTE: all speakers are supplied with finish grid.

TECHNICAL DATA						
	NV-2IC6	NV-2IC6-ANG	NV-2IC6-DVC	NV-2IC8	NV-2IC8-ANG	NV-2IW6
Frequency	60 Hz - 20 KHz	60 Hz - 20 KHz	55 Hz - 20 KHz	45 Hz - 20 KHz	45 Hz - 20 KHz	60 Hz - 20 KHz
Impedance	8 Ohms	8 Ohms	8 Ohms	8 Ohms	8 Ohms	8 Ohms
Sensitivity	86 dB	86 dB	86 dB	86 dB	86 dB	86 dB
RMS power	50 W	50 W	50 W	50 W	50 W	50 W
Peak power	100 W	100 W	100 W	100 W	100 W	100 W
Woofer material	Polypropylene	Polypropylene	Polypropylene	Polypropylene	Polypropylene	Polypropylene
Tweeter material	Silk	Silk	Silk	Silk	Silk	Silk
Weight (kg)	3.28	1.80	1.97	1.97	2.58	3.60
Dimensions of the Woofer	165 mm	165 mm	165 mm	203 mm	203 mm	165 mm
Dimensions of the Tweeter	13 mm	13 mm	13 mm	13 mm	13 mm	13 mm
Dimensions	230 mm	230 mm	230 mm	270 mm	285 mm	220 mm x 300 mm
Size for flush mounting	205 mm	205 mm	205 mm	246 mm	258 mm	194 mm x 274 mm
Depth for flush mounting	99 mm	116 mm	99 mm	111 mm	135 mm	83 mm

CATALOGUE

Speakers SERIES 4



NV-4IC6







NV-4IC6-DVC

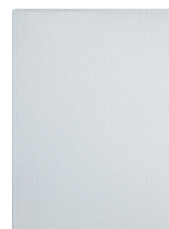

NV-4IW6



Item	FOR CEILING INSTALLATION	
NV-4IC6		6.5" ceiling speaker, Series 4 (a pair) 75W RMS 8Ω
NV-4IC6-ANG		6.5" ceiling speaker, Series 4 (single) 75W RMS 8Ω - angle
NV-4IC6-DVC		Ceiling speaker with double tweeter 6.5" Series 4 (single) 75W RMS 8Ω
NV-4IC8		8" ceiling speaker, Series 4 (a pair) 75W RMS 8Ω
NV-4IC8-ANG		8" ceiling speaker, Series 4 (single) 75W RMS 8Ω - angle

Item	FOR WALL AND FLUSH MOUNTED INSTALLATION	
NV-4IW6		6.5" wall speaker Series 4 (a pair) 75W RMS 8Ω. For flush mounted installation in cement or brick walls, use the box item NV-BOXIW6.

NOTE: all speakers are supplied with finish grid.

TECHNICAL DATA						
	NV-4IC6	NV-4IC6-ANG	NV-4IC6-DVC	NV-4IC8	NV-4IC8-ANG	NV-4IW6
Frequency	55 Hz - 20 KHz	55 Hz - 20 KHz	50 Hz - 20 KHz	40 Hz - 20 KHz	40 Hz - 20 KHz	55 Hz - 20 KHz
Impedance	8 Ohms	8 Ohms	8 Ohms	8 Ohms	8 Ohms	8 Ohms
Sensitivity	88 dB	88 dB	88 dB	88 dB	88 dB	88 dB
RMS power	75 W	75 W	75 W	75 W	75 W	75 W
Peak power	150 W	150 W	150 W	150 W	150 W	150 W
Woofer material	Glass fibre	Glass fibre	Glass fibre	Glass fibre	Glass fibre	Glass fibre
Tweeter material	Aluminium	Aluminium	Aluminium	Aluminium	Aluminium	Aluminium
Weight (kg)	3.72	2.01	2.26	4.35	2.58	3.95
Dimensions of the Woofer	165 mm	165 mm	165 mm	203 mm	203 mm	165 mm
Dimensions of the Tweeter	19 mm	19 mm	19 mm	19 mm	19 mm	19 mm
Dimensions	230 mm	230 mm	230 mm	270 mm	285 mm	220 mm x 300 mm
Size for flush mounting	205 mm	205 mm	205 mm	246 mm	258 mm	194 mm x 274 mm
Depth for flush mounting	100 mm	121 mm	100 mm	112 mm	141 mm	83 mm

Speakers SERIES 6



NV-6IC6







NV-6IC8-ANG



NV-6IW6



Item	FOR CEILING INSTALLATION	
NV-6IC6		6.5" ceiling speaker, Series 6 (a pair) 100 W RMS 8Ω
NV-6IC6-ANG		6.5" ceiling speaker, Series 6 (single) 100 W RMS 8Ω - angle
NV-6IC8		8" ceiling speaker, Series 6 (a pair) 100 W RMS 8Ω
NV-6IC8-ANG		8" ceiling speaker, Series 6 (single) 100 W RMS 8Ω - angle

Item	FOR WALL AND FLUSH MOUNTED INSTALLATION	
NV-6IW6		6.5" wall speaker Series 6 (a pair) 100 W RMS 8 Ω. For flush mounted installation in cement or brick walls, use the box item NV-BOXIW6.

NOTE: all speakers are supplied with finish grid.

TECHNICAL DATA					
	NV-6IC6	NV-6IC6-ANG	NV-6IC8	NV-6IC8-ANG	NV-6IW6
Frequency	60 Hz - 20 KHz	60 Hz - 20 KHz	35 Hz - 20 KHz	35 Hz - 20 KHz	50 Hz - 20 KHz
Impedance	8 Ohms	8 Ohms	8 Ohms	8 Ohms	8 Ohms
Sensitivity	89 dB	89 dB	89 dB	89 dB	89 dB
RMS power	100 W	100 W	100 W	100 W	100 W
Peak power	200 W	200 W	200 W	200 W	200 W
Woofer material	Kevlar/Carbon Fibre Weave	Kevlar/Carbon Fibre Weave	Kevlar/Carbon Fibre Weave	Kevlar/Carbon Fibre Weave	Kevlar/Carbon Fibre Weave
Tweeter material	Titanium	Titanium	Titanium	Titanium	Titanium
Weight (kg)	3.79	2.01	4.35	2.58	3.95
Dimensions of the Woofer	165 mm	165 mm	203 mm	203 mm	165 mm
Dimensions of the Tweeter	25 mm	25 mm	25 mm	25 mm	25 mm
Dimensions	230 mm	230 mm	270 mm	285 mm	220 mm x 300 mm
Size for flush mounting	205 mm	205 mm	246 mm	258 mm	194 mm x 274 mm
Depth for flush mounting	100 mm	121 mm	112 mm	141 mm	83 mm

CATALOGUE

Series 2 and Series 6 outdoor speakers - wall-mounted installation Landscape Sneakers - LCR Speakers







NV-20D6-WH





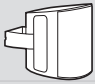
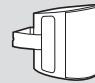
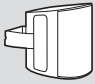



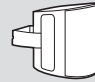

NV-20D6-BK



NV-2LSK-BK

Item	SERIES 2
 NV-20D6-WH	6.5" speaker, White, (a pair) 50 W RMS 8 Ω
 NV-20D6-BK	6.5" speaker, Black, (a pair) 50 W RMS 8 Ω
 NV-20D5-WH	5.25" Outdoor Speaker, White, (a pair) 40 W RMS 8 Ω
 NV-20D5-BK	5.25" Outdoor Speaker, Black, (a pair) 40 W RMS 8 Ω
 NV-2LSK-BK	Series Two Landscape Satellite Speakers Complete 5-piece system
 NV-2LSK-SAT2BK	Series Two Landscape Satellite Speakers set of 2 Satellite Speakers

Item	SERIES 6
 NV-60D6-WH	6.5" speaker, White , (a pair) 60 W RMS 8 Ω
 NV-60D6-BK	6.5" speaker, Black, (a pair) 60 W RMS 8 Ω
 NV-60D6-DVC-WH	6.5" stereo speaker White, 50 W RMS 8 Ω
 NV-60D6-DVC-BK	6.5" stereo speaker Black, 50 W RMS 8 Ω
 NV-60D5-BK	5.25" Outdoor Speaker, Black, (a pair) 50 W RMS 8 Ω
 NV-60D5-WH	5.25" Outdoor Speaker, White, (a pair) 50 W RMS 8 Ω
 NV-60D5-DVC-BK	5.25" DVC Outdoor Speaker, White, 60 W RMS 8 Ω
 NV-60D5-DVC-WH	5.25" DVC Outdoor Speaker, White, 60 W RMS 8 Ω

TECHNICAL DATA			
	NV-20D6-WH NV-20D6-BK	NV-60D6-WH NV-60D6-BK	NV-60D6-DVC-WH NV-60D6-DVC-BK
Frequency	60Hz - 20KHz	55Hz - 20KHz	55Hz - 20KHz
Impedance	8 Ohms	8 Ohms	8 Ohms
RMS power	50 Watts	60 Watts	60 Watts
Peak power	100 Watts	120 Watts	120 Watts
Dimensions	195mm x 328mm x 178mm	195mm x 328mm x 178mm	195mm x 328mm x 178mm

CATALOGUE

Home Theaters - Subs



NV-2IW5-LCR



NV-SUB10

Item	LCR (LEFT, CENTER, RIGHT) SPEAKERS
NV-2IW5-LCR	5.25" LCR wall speaker Series 2, 50 W RMS 8 Ω.
NV-4IW5-LCR	5.25" LCR wall speaker Series 4, 75 W RMS 8 Ω.
NV-6IW6-LCR	6.5" LCR wall speaker Series 6, 100 W RMS 8 Ω.

Item	POWERED SUBWOOFERS
NV-SUB8	8" Powered Subwoofer
NV-SUB10	10" Powered Subwoofer
NV-SUB12	12" Powered Subwoofer

Item	PASSIVE SUBWOOFERS
NV-SUBIC8	In-Ceiling Passive 8" Subwoofer
NV-SUBIW8	In-wall Single Passive 8" Subwoofer
NV-SUBIWDUAL8	In-wall Dual Passive 8" Subwoofer

NV-SUBTXRX	Wireless Subwoofer Kit
------------	------------------------

Item	
NV-SUBAMP100	100 Watt Wall mount Subwoofer Amplifier
NV-SUBAMP200	200 Watt Rack mount Subwoofer Amplifier
NV-SUBAMP500	500 Watt Rack mount Subwoofer Amplifier



NV-RGIC6







NV-RGIW6

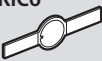
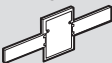

NV-BOXIW6

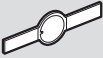
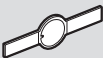
Item	FLUSH MOUNTED BOX
NV-BOXIW6	Metal box for installation of the speakers item NV-2IW6, item NV-4IW6 and item NV-6IW6 on brick walls.

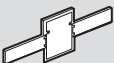
SUPPORTS FOR CEILING SPEAKERS	
NV-BRKIC6 	Fixing system for 6.5" ceiling speakers (a pair)
NV-BRKIW6 	Fixing system for 6.5" wall speakers (a pair)
NV-BRKIC8 	Fixing system for 8" ceiling speakers (a pair)
NV-BRKIC6-ANG 	Fixing system for 6.5" ceiling angle speaker
NV-BRKIC8-ANG 	Fixing system for 8" ceiling angle speaker
NV-BRKIW5-LCR 	5.25" LCR Speaker Bracket
NV-BRKIW6-LCR 	6.5" LCR Speaker Bracket

Item	SQUARE FINISH GRIDS
NV-RGIC6-SQR	Square pair of grids for ceiling speakers with 6.5" diameter.
NV-RGIC6-ANG-SQR	Square pair of grids for ceiling angled speakers with 6.5" diameter.
NV-RGIC8-SQR	Square pair of grids for ceiling speakers with 8" diameter.
NV-RGIC8-ANG-SQR	Square pair of grids for ceiling angled speakers with 8" diameter.



Use of the box item NV-BOXIW6 for the installation of the speaker item NV-6IW6



 **legrand**[®]

**INTEGRATED
SOLUTIONS**

Legrand Integrated Solutions nv/sa
Binnenijk 40, 9130 Beveren
Belgium
T: +32 (0)3 773 31 06
www.legrandintegratedsolutions.com