



---

TPro-30 Motorised Curtain Track System  
Set Up and User Guide



# TPro-30 Motorised Curtain Track System - Set Up and User Guide V1.1



## Features

- AC100-240V, widen voltage input for different voltage power area
  - Light touch to start the motor by softly dragging the curtain fabric, it will open or close the curtain automatically
  - When the electricity is off, it can be manually operated
  - You can set a third limit in the middle between the open and close points
  - Soft start and soft stop, quiet and smooth running
  - It takes the first open and close position as its stops, and preserves gaps between pulleys and gears to avoid parts clashing.
- **Flexible quiet design:** high-precision drive, leading intelligent design, slow open and close make it a light and smooth operation.
- **Various control:** According to the application, option for RF control, hard wire, Rs485 bus line control etc.
- **Remember limits:** Motor remembers the first open and close stops even after power cuts.

## Parameters

Model number	Rated torque	Speed	Housing size	Rated voltage	Rated power	IP level
AM68-1/80-EM-GP	1N.m	14cm/s	310×68×50mm	AC100-240V 50/60Hz	65W	IP20
AM68-2/80-EM-GP	2N.m	14cm/s	310×68×50mm	AC100-240V 50/60Hz	80W	IP20

## Loading diagram

Track length	Single motor with double pulley	Single motor with single pulley	Single motor with double pulley R500	Single motor with single pulley R500	Single motor with double pulley R500	Single motor with single pulley R500	Single motor with double pulley R3000	Single motor with single pulley R3000
4m	90kg	75kg	67.5kg	60kg	52.5kg	45kg	46.5kg	31.5kg
8m	82.5kg	67.5kg	60kg	52.5kg	45kg	37.5kg	31.5kg	24kg
12m	75kg	60kg	52.5kg	45kg	37.5kg	30kg		

## Structure and accessories

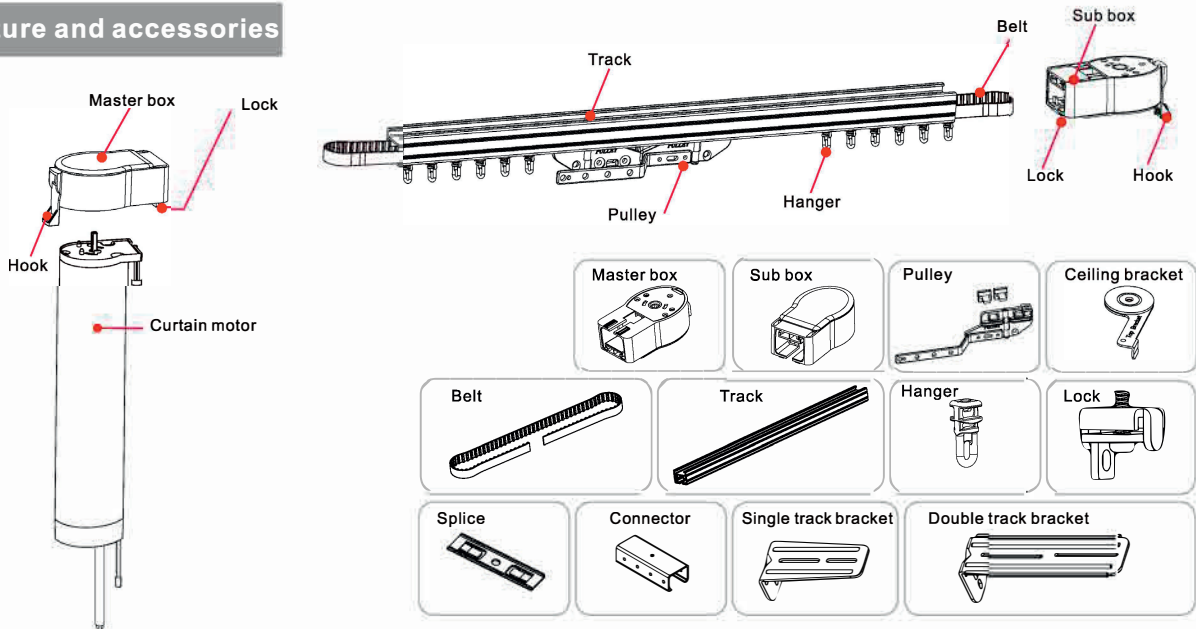

## Solution



① Single motor with single pulley

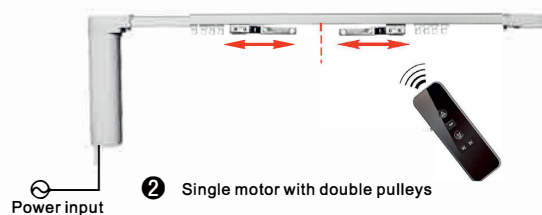

② Single motor with double pulleys

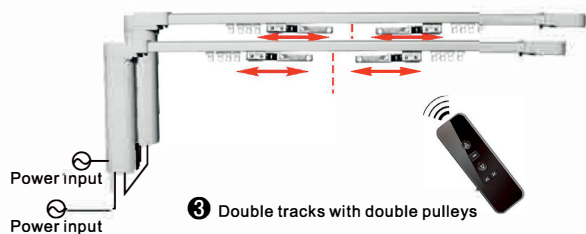

③ Double tracks with double pulleys

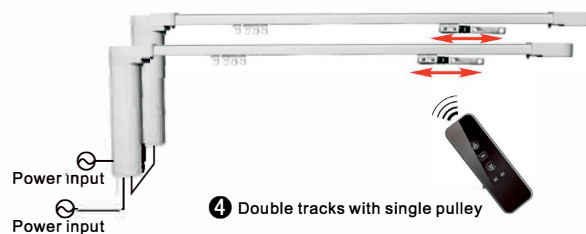

④ Double tracks with single pulley

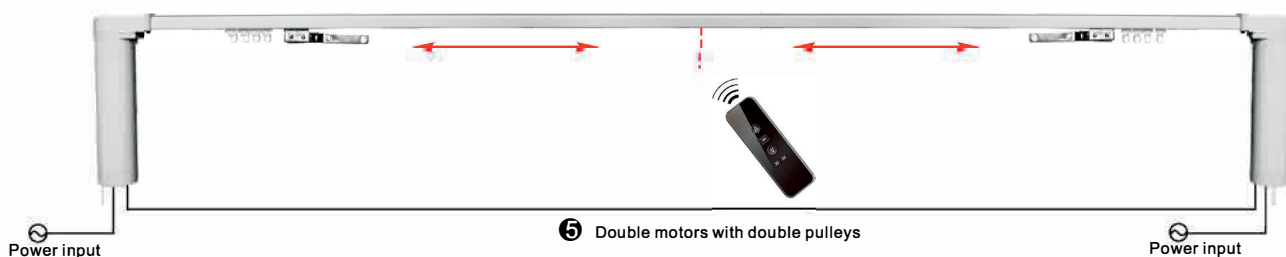

⑤ Double motors with double pulleys

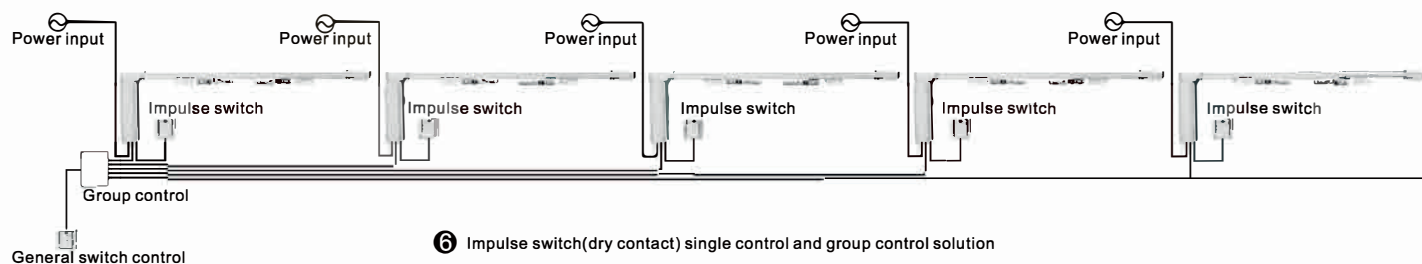

⑥ Impulse switch (dry contact) single control and group control solution

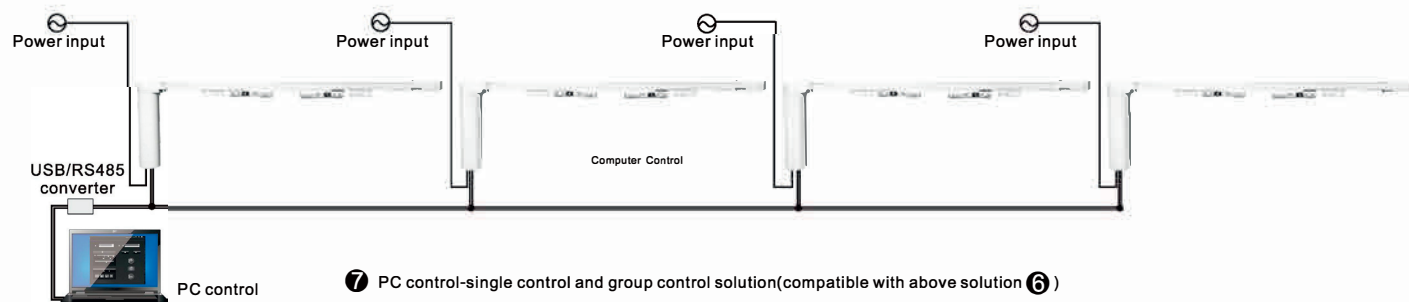

⑦ PC control-single control and group control solution (compatible with above solution ⑥)

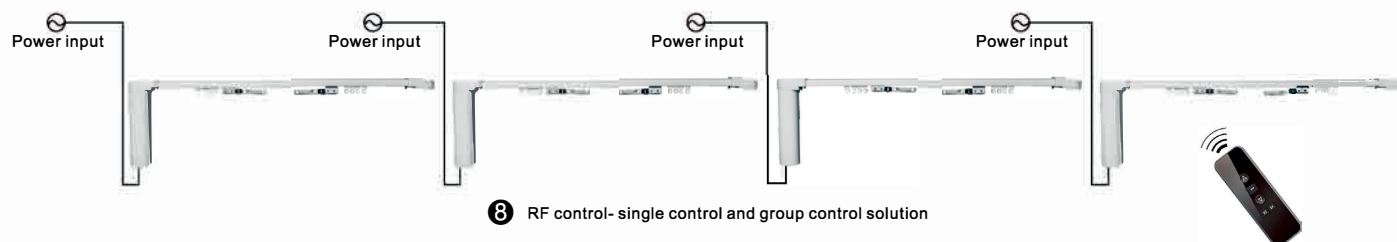

⑧ RF control- single control and group control solution



## Installation and wiring

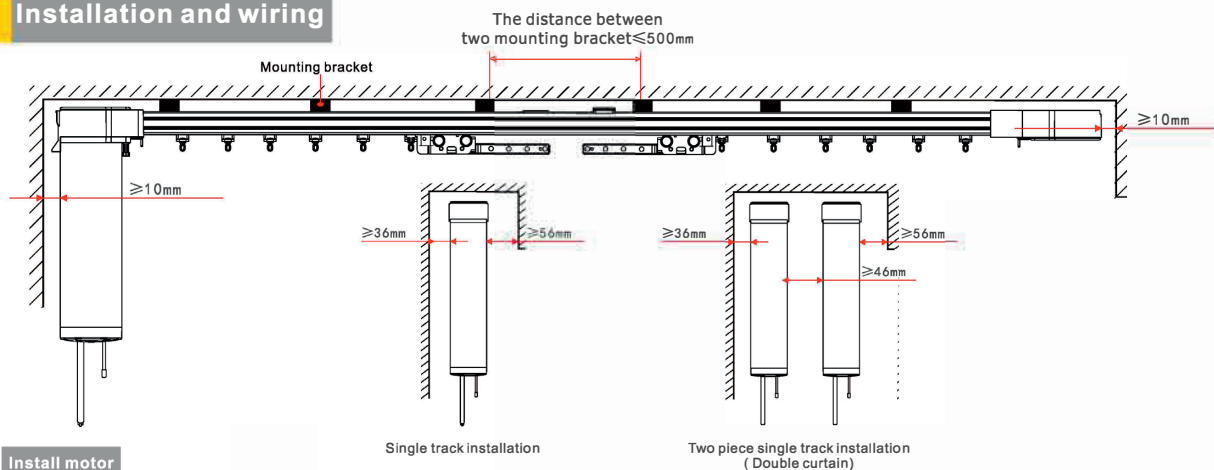

### Install motor

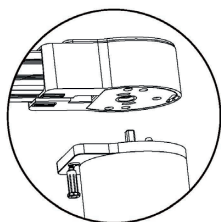

1. Please check and keep the lock bar at the left side as the image

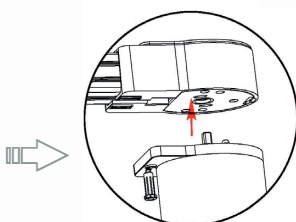

2. Insert the motor to main box

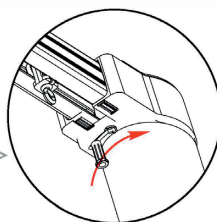

3. Slide the lock bar and make sure it is in the limit hole on the right

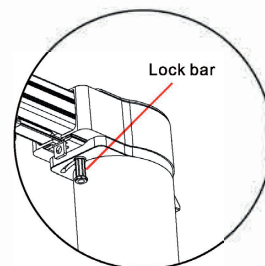

### Remove motor

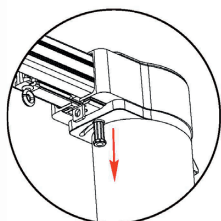

1. Pull the lock bar and make it slide out of the limit hole

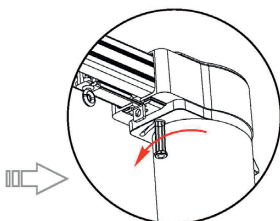

2. Slide to the left

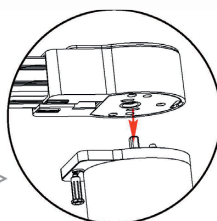

3. Removing motor



### Caution

- Please follow the installation drawing above
- Make sure the lock bar in the correct position as image
- Ceiling must be strong enough to hold the track, motor and curtain

## Wiring

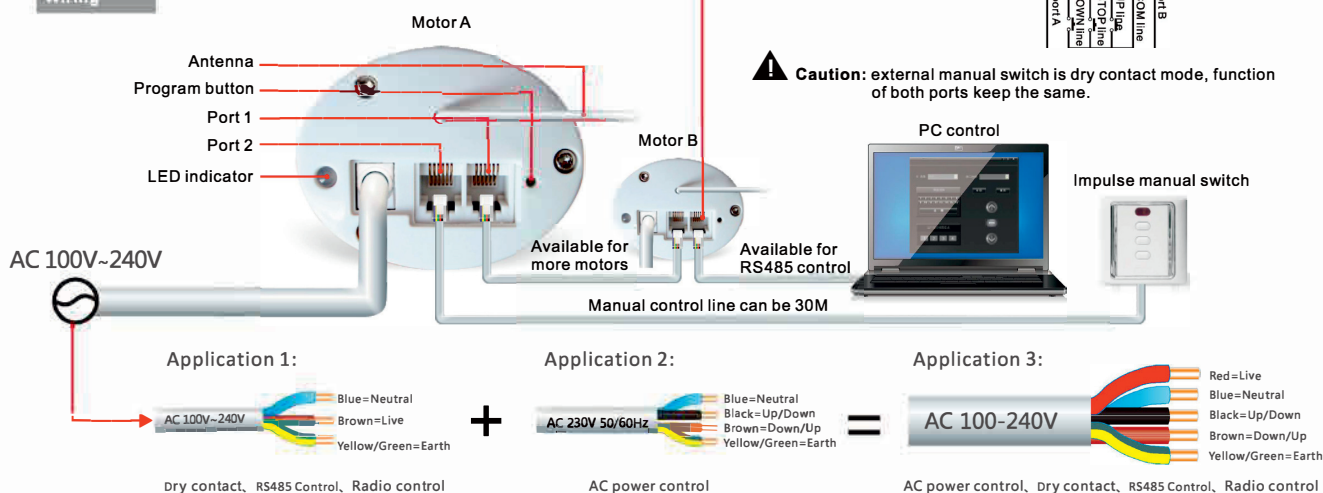

## Functions

### Automatical remember journey

Motor stop at the open and close ends during the first operation, and keep it as the stop journey even the power off and on again

### Over current protection

Able to effectively avoid electric parts burnt or damage with over loading, and its coming fire damage. If there are two times short circuit caused by over loading in 1min, the red indicator light, the motor enter into protection mode. It has to be repower to start again

## Operation instructions

Please select channel for multi-channel transmitter before operation  
0.5s is needed for up/down converting, max single running time is 4 min

### 1 Programming

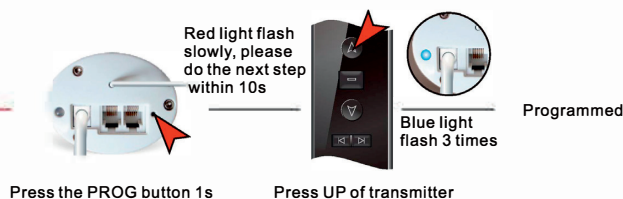

### 2 Changing direction

In the case of the motor goes in wrong direction



### 3 Mid-limit position setting

Only one can be set

Mid-limit position set



Middle position operation

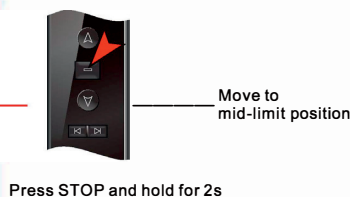

Middle position delete



### 4 New transmitter adding



### 5 Single code deleting

If you are using multiple channel transmitter please select the channel first



### 6 All code deleting

Journey will be deleted and the running direction will be the factory defaulted mode, keeping the touch function

Method 1

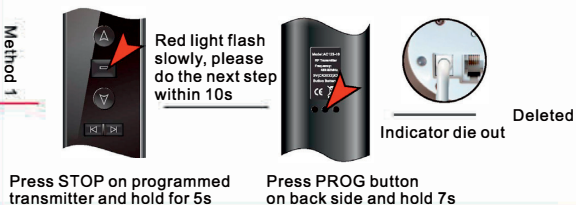

Method 2

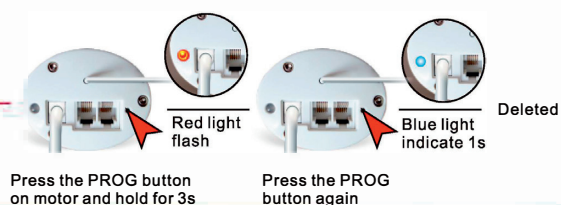

### 7 Manual function setting

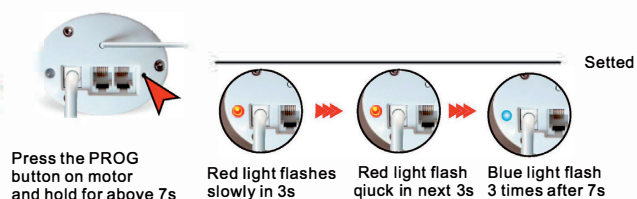

Manual function demonstration

